

# McBride AG Foods

250-569-0140

**ALWAYS CANADIAN**

## SUPER SAVER

prices in effect to Nov. 2, 2024

HOURS: Monday to Saturday: 6:30am to 6:30pm  
Sunday: 9:00am to 5:00pm

**SENIOR'S DAY 65+**  
Every Wednesday - 10% Off

**FRESH FISH FRIDAYS**

For All Your

## FIREWOOD NEEDS

Serving Valemount to McBride  
\$250 round - \$300 split Full Cord  
Discounts Available  
Terrance Pallagi 250-569-4280

## Gigglin' Grizzly Pub

Taking Fall Break starting October 14th,  
see you in November, date TBA.

Grizzly RV Park - 250-569-0128  
24 fully serviced sites  
(water, sewer, 30/50 amp)

Pub & RV Park for sale



250-569-2666

1021 SE Frontage Road

## LICENSED AUTOMOTIVE & DIESEL MECHANIC

MONDAY to FRIDAY 8:30am - 4:30pm  
SATURDAY & SUNDAY - CLOSED

OCTOBER IS BREAST CANCER AWARENESS MONTH.  
JOIN US EVERY FRIDAY THIS MONTH FOR REGULAR COFFEE BY DONATION.  
PROCEEDS GOING TO THE BREAST CANCER SOCIETY OF CANADA.

### WHATS FOR LUNCH?

WED - BUTTERNUT SQUASH SOUP/GRILLED BRIE CIABATTA  
THUR - SMOKY BACON MAC & CHEESE/TOASTED BUN  
FRI - POTATO BACON SOUP/HAM & CHEESE PANINI  
CALL US OR CHECK OUR FB PAGE FOR OUR DAILY SPECIALS!

Monday - Saturday - 8:30am - 4 pm  
Follow us on Facebook - fb.me/youarewelcomehome  
Call us - 250-569-0215

## HISTORIC MCKALE HOUSE

421 Main Street 250-569-7176

We're back and getting ready to start our  
**CLOSING OUT SALE!**

Watch here and on FB for updates!  
The store will open Thurs. Oct. 24 11 am.  
Reg. Hours: Thurs.-Fri. 11-4; Sat 10-2

## FOREVER PRINTING & SIGNS

Home of The Little McBride Paper

Phone: 250-569-3110

email: contact@fpas.ca www.fpas.ca

## YRB Yellowhead Road & Bridge

Slim Creek is accepting applications for plow truck operators for the 2024/2025 winter season.  
Applicants need minimum Class 3 with Air.  
Wages and benefits as per  
B.C.G.E.U Collective Agreement.  
Send resume with driver's abstract to  
Don Danroth  
General Delivery, Dome Creek V0J 1H0 or  
dond@yrb.ca phone 250-981-3879

## Whistle Stop Gallery



Open 9am to 5pm daily in the train station

Did you know that most of the public art you see in McBride has been sponsored and created by Whistle Stop Gallery artists?

We have over 100 local artists and crafters showing their work in the Gallery and working to make the Robson Valley Beautiful.

Visit the Gallery and see how our artists and artisans are helping build community through culture!

250-569-8891

## FREE The Little FREE

# McBride Paper



Serving BC's Friendliest Town and Area since 1996!!!

For the week of Wednesday, October 16<sup>th</sup>, 2024

## FOOD BANK NEWS

Annual Fall Food Drive, Mon., Oct. 21 from 6-8pm. Please leave your donation of non-perishable food in a disposable bag or box and leave by your door. Volunteers will collect the donations between 6 and 8 pm. Should we miss your house please leave your donation in the drop box at the post office. The local Fire Department will be assisting the volunteers. Thank you for your amazing support of our local food bank program. Contact is Julie Holland 250-569-7436.

## HEALTH NEWS

Covid & Influenza vaccinations available at McBride Community Health Services (1126 - 5th Avenue) on the following dates:

Tuesday, October 22nd - 9am to 3:30pm.

Tuesday, October 29th - 9am to 3:30pm.

Wednesday, November 6th - 9am to 3:30pm.

Please call 1-833-838-2323 or 250-569-2026 to book an appointment.

## OPEN GATE GARDEN NEWS

Open Gate Community Garden Society Annual General Meeting Saturday, October 26, 2024 @ 1:30pm in the McBride and District Public Library. New Gardeners welcome!

## GRAFT FAIR

McBride Secondary Craft Fair - Sunday, December 1st at the Robson Valley Community Hall from Noon - 4:00 p.m. Admission is \$2.00 - name will be entered in raffle. Come out and support your community by doing some early Christmas shopping from local crafters and bakers on Sunday, December 1st. There will be a concession provided by the McBride Secondary Home Ec. students and the Girls Volleyball team. If you would like to be a vendor, tables are \$25.00 plus a \$5.00 value, gift (for raffles). Please contact Kathy Molendyk for more information, at 250-569-7201 asap as there are limited tables.

## BIRTHDAY WISHES OCT. 16-22

Branton Thiel, Keith Perkins, Hailey Carmont, Nadine Shovar, Shawna Melnychuk, Katharina McNaughton, Ryler Penner, Nova Gladys Barnes, Bridget Uhl, Gillian Hooker, Pete Amyony, Shelby Trask, Harlen Whitford, Travis Smith, Wade Phillips, and to any we have missed, Happy Birthday!



Corporation of the Village of McBride

P.O. Box 519 McBride, BC V0J 2E0

Phone: 250-569-2229 Fax: 250-569-2376

## NOTICE OF PERMISSIVE TAX EXEMPTION BYLAW NO. 831, 2024 October 8, 2024

Pursuant to the Community Charter, section 227, notice is hereby given that The Village of McBride Council will consider the "The Village of McBride Permissive Tax Exemption Bylaw No. 831, 2024" during the regular meeting being held Tuesday, October 22, 2024, 6:00 pm in Council Chambers, Village Office, 100 Robson Centre, McBride, BC.

Bylaw No. 831, 2024 proposes property tax exemptions for a term of ten (10) years (2025 - 2034) for the properties shown below. The estimated value of municipal permissive property tax exemptions are shown for the years 2025, 2026 & 2027, and are proposed in accordance with Section 224 of the Community Charter for properties that are owned or held by a charitable, philanthropic, or other not-for-profit corporation.

Organization Name	Property Address	Estimate of Annual Taxes		
		2025	2026	2027
St. Pauls United Church	459 Dominion Street	\$1,146.97	\$1,227.25	\$1,264.07
Roman Catholic Episcopal	199 Dominion Street	\$693.83	\$714.65	\$736.09
Roman Catholic Episcopal	197 Dominion Street	\$935.50	\$963.57	\$992.47
Pentecostal Assemblies of Canada	299 Main Street	\$1,732.63	\$1,784.61	\$1,838.15
McBride Evangelical Free Church	135 Lonsdale Street	\$3,101.77	\$3,194.82	\$3,290.67
Open Gate Community Garden Society	1067 2nd Avenue	\$379.71	\$391.10	\$402.84
<b>Total</b>		<b>\$7,990.41</b>	<b>\$8,276.00</b>	<b>\$8,524.28</b>

Jeanette McDougall  
Chief Administrative Officer /  
Corporate Officer

All our trains are back! Drop by McBride Station for more information!  
VIA Rail Schedule viarail.ca Phone: 1-888-842-7245  
Going West, Train #5 - Sundays, Wednesdays, Fridays...2:44pm  
Going East, Train #6 - Mondays, Thursdays, Saturdays...12:18pm  
Dome car included! Baggage car - bikes, caged pets, kayaks (fees apply).

## Important Phone Numbers

EMERGENCY ..... 9-1-1 Gov't Serv. BC 250-569-3760  
R.C.M.P. .... 250-569-2255 Village ..... 250-569-2229  
Hospital ..... 250-569-2251 Reg'l Dist' ..... 1-800-667-1959  
Health Unit ..... 250-569-2251 RV Comm. Srv. 250-569-2266  
K to 7 School .. 250-569-2721 Food Bank ..... 250-569-3186  
High School ..... 250-569-2295 Fire Hall ..... 250-569-3117  
The Little McBride Paper 250-569-3110  
BC BUS...844-564-7494 Report Forest Fires - 1-800-663-5555  
Inquiry B.C.-1-800-663-7867 - For Toll Free Calling to Provincial Numbers ...  
Dial this Number 1st and ask operator to connect you to provincial department.

Take a Break in McBride...B.C.'s Friendliest Town!!

## FUN FRIDAY

October 18th - 10am to 5pm

Fresh Cinnamon Buns & FREE Frog Coffee all day!!  
Friday, October 18th

FREE SAMPLES All Day to 5pm!!  
Rain Coast Wild Organic Salmon Jerky  
Smokey Sweet Chipotle & Original  
& Home-made Organic Lemonade

Wed 16th to Tues 22nd

20% OFF

Rain Coast Organic  
Wild Salmon Jerky  
& 20% OFF ITALIAN Volcano  
Organic ITALIAN Lemon Juice

Open

Mon to

Friday

10 - 5



A Local & Organic Grocery Store & More!!  
Jerky, Sausage, Produce, Baking, Dairy, Bulk Goods  
926 - 1st Ave, McBride (250) 569-3003  
eat@unclemarks.ca www.unclemarks.ca

Delivering Fuel  
East to McBride &  
Valemount



Four Rivers  
Co-operative

Commercial, Farm & Personal

Visit our Gas Bar in Prince George!  
6749 Westgate Avenue - Tel: 250.964.2697

Prince George:  
Tel: 250.564.3488  
TF: 866.309.2667  
Fax: 250.564.3433

Valemount Cardlock:  
1500 - 9th Avenue  
Valemount BC  
TF: 866.309.2667

McBride Cardlock:  
2130 Zeidler Road  
McBride BC  
TF: 866.309.2667

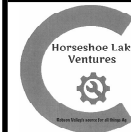

HORSESHOE LAKE VENTURES

377 Main Street McBride, B.C.

250-569-0075

## Robson Valley's Source for all things Ag.

• Feed and Farm Supplies • Dog and Cat Food  
• Full Hydraulic Hose and Fitting Supply  
• Agricultural Parts/Repair • Automotive Parts/Accessories

## BRKH Custom Woodworks Ltd.

Quality Millwork. 894 1st Ave, McBride

Douglas Fir  
Cedar  
Spruce  
Birch  
Pine



V-Joint  
Flooring  
Decking  
S4S  
Shiplap  
Moulding  
Custom  
Work  
Channel  
Siding

admin@brkh.ca 250-569-3175 www.brkh.ca

## ROBSON VALLEY

## DRY WALL SERVICES

Board and Tape 778-201-7114

@robsonvalleydrywallservices

Most Christians believe we get our reward at death.  
The Bible teaches we get our reward at two separate  
resurrections. Which do you believe?  
Contact Bible Truth. Phone 250-569-7077. Box 185, McBride. B.C.



## Tete Jaune Cache & Valemount Residents!

Integris is opening a branch in McBride!  
Join this info session to learn more about  
cooperative local banking for Tete Juane  
and Valemount residents.

October 29th | Tete Jaune Community Hall  
7:00pm | 14240 Blackman Road  
(Doors open at 6:30PM) | Tete Jaune Cache BC



McBride & District 250-569-2411  
**PUBLIC LIBRARY**

521 Main Street McBride, BC V0J 2E0

Regular Library Hours

Tues. 10-6,

Wed. and Thurs. 10-5,

Fri. 1-8, and Sat. 1-5

library@mcbridebc.org mcbride.bc.libraries.coop

## ROBSON VALLEY I.D.A. TELE PHARMACY

We are open Monday-Friday 9-5  
Closed Saturday & Sunday  
www.robsonvalleyidapharmacy.com  
250-569-8811  
#3 - 411 Main Street, McBride

**On October 22nd Come on In and Receive a Free Plush Blanket with a purchase of**

**\$50 or more of Front Store products.**

*\*Limit of 1 Blanket per person\*  
\*Blankets are exempt from Promo\**

Also:

**For the Month of October Purchase \$25.00**

**In Atoma or Option+ Products and receive a Free Atoma Shopping Bag.**

*(Both Promotions While Supplies Last)*



## VALLEY MUSEUM & ARCHIVES

NEW EXHIBIT:

### Up Around the Bend

featuring artist Emily Wilson

This Two Rivers Regional Outreach Show will be up for one month only!

OPEN Tuesday to Friday 11-4pm



Corporation of the Village of McBride

P.O. Box 519 McBride, BC V0J 2E0  
Phone: 250-569-2229 Fax: 250-569-2376

#### NOTICE OF PUBLIC HEARING

Public Hearing regarding Zoning Amendment  
Bylaw 830, 2024.

Tuesday, October 22, 2024, 6:00 pm

Village of McBride, Council Chambers

100 Robson Centre, McBride, BC V0J 2E0

**OWNER & APPLICANT:** The Village of McBride

**PROPOSAL:** The Village of McBride is proposing to re-zone the subject property to add site specific uses to add the following under the Public Development Zone, section 22.0:

- Subsection 22.3: In the Public Development (PD)

Zone: the following ACCESSORY uses are permitted:

RESIDENTIAL-ONE FAMILY-accessory to Church and Hospital use only, and site specific to the location of the Airport Hangars located at the aerodrome and to be contained within Airport Hangars; and COMMERCIAL (airside activities, eg maintenance) - accessory to Airport Hangar use and site specific to the location of the Airport Hangars located at the aerodrome.

#### SUBJECT PROPERTY:

McBride Airport - 990 Airport Road

Area-Jurisdiction-Roll: 26-545-00312.007

Part SE 1/4, District Lot 3539, Cariboo Land District,

Except Plan PGP39229

PID: 015-225-666

#### WRITTEN SUBMISSIONS:

Written submissions will only be accepted in advance of the public hearing until 12:00 pm, Monday, October 21, 2024 and must be sent by the following:

- email at cao@mcbride.ca / In-Person Delivery / Mail: Attention: Corporate Officer, Village of McBride, 200 Robson Centre, McBride, BC V0J 2E0 / Fax: 250-569-3276.

#### Corporation of the Village of McBride

No written submissions will be received after 12:00 pm, Monday, October 21, 2024 unless they are submitted in person at the public hearing meeting and all written submissions must include the legible legal name of the author.

Note: A copy of the proposed Bylaw is available for review at the Village of McBride Office, 100 Robson Centre, McBride, BC during the hours of 8:30 am - 4:30 pm, Monday, Tuesday, Thursday & Friday; Wednesdays during the hours of 10:00 - 4:30 pm, from October 8 - 22, 2024, excluding Monday, October 14, 2024.

#### LOCATION

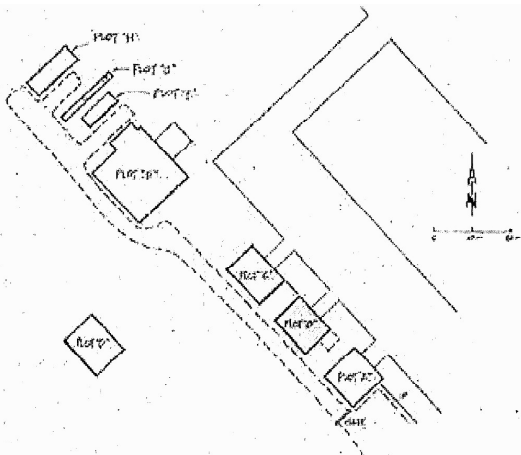

Jeanette McDougall

Chief Administrative Officer / Corporate Officer

## COMING EVENTS

ASL Sign Language Club Tuesdays, 3pm - 3:30pm Basics. 3:30 - 4:30pm Beyond Basics. Great for families, friends and cognitive brain stimulation. Held @ E-Free Church McBride. Contact Lonnie 250-569-7657.

## COMMUNITY CALENDAR

**McBride Elks/Royal Purple Community Calendar Sales.** If you are interested in purchasing a 2025 McBride Elks/Royal Purple please stop by Mountainview Boutique to prepay for your Community Calendar. Calendars remain at \$11.00 each. Members will be contacting those that purchased a calendar last year. If you bought one last year, Mountainview Boutique (Gina) will have the list of your birthdays, anniversaries and memorial dates. If you are new, she will have a form to fill out or bring in a list of dates you would like to be on the 2025 calendar. If you want to renew your ad or would like to purchase an ad square (if available), they are \$40 small ad, and \$50 large ad. This includes a free calendar (includes your celebration dates). Please contact Kathy Molendyk at 250-569-7201. Deadline to order your calendar is Friday, October 25th. The McBride Elks/Royal Purple thank you for your support!

## LIBRARY NEWS

**McBride Library's 75!** - Sat., October 19th, 2-5pm. Join us at the library for a party to celebrate the 75th anniversary of McBride Library! Cake, refreshments, prizes and kids' activities. Come dressed as a favourite author or character from a book: prizes for the best-dressed adult and child!

**German Conversation Club** - Join Lilly on Wednesdays at the NEW TIME of 11.30am-1pm for vocab building and conversation. All levels welcome.

**Uncomfortable Discussions** - next session on Wed., 16th October, 3-5pm. Facilitated by Elizabeth Surridge.

**Miniature Figure Painting** - Sat., 26th Oct. 1.30-3pm. Another painting workshop led by expert Jeff Nadwidny. Ages 10-adult.

**One-to-one help** - Provided by our Literacy Outreach Coordinator, Cathy. Cathy can help with forms and other paperwork, or internet queries, etc. Every second Wednesday morning, from 10.30am-12pm. Do you know someone who would like to be read to? Not all books have been made into audiobooks, but Cathy can read any favourites to interested adults or children. Please call us for details or to set up an appointment. Next time you're in the library, check out our Word of the Week!

**D&D for Teens** - Tues., 3.30-5pm. Ages 12-18. Please call for details: 250 569 2411.

**Sunshine Stories** - Every Thurs. 10.30-11.00am. For 0-5s and caregivers; songs, stories and fun! In partnership with Decoda Literacy Solutions/Literacy Task Group.

**Board Teens** - Thurs. 3-5pm. A drop-in session for those ages 12-18 to enjoy some of the library's many board games. Have a favourite game you like to play? Bring it along!

**Book Clubs for Adults** - We now have two monthly book discussion clubs for adults, on Thursday afternoons at 1.30pm. Call for details: 250 569 2411.

**Weekly Adults' Programs** - Fibre Artists Knit & Crochet Group (Wed., 10am) - beginners welcome; Writing Group (Fri., 1.30pm). Call 250 569 2411 for details of either program.

## RVGS NEWS

**MONs Family Place Drop-In** is on Mondays from 9am-noon at RVCS (942 3rd Ave., McBride) unless otherwise stated. Join for connection with other families, parenting resources and fun for you and your 0-6 year old children. Registration is not required unless otherwise stated. For more information call 250-569-2266 or email: events@rvcsbc.org. October 21 - Lets make slime! October 28 - Halloween pumpkin salt dough handprint.

**THUR., October 17th** Join us for our Tech Drop-In between 11-3 at RVCS McBride 942 3rd Ave. Our literacy program will help you learn about your technology and answer questions. No registration required, for more information call 250-569-2266 or email: events@rvcsbc.org. This program is brought to you by the McBride Adult Literacy Program.

**THUR., October 24th** from 1pm-3:30pm Join us for Table Talk to journal about a given topic and then share if you desire and discuss at the RVCS office in McBride, 942 3rd Ave. No registration required, for more information call 250-569-2266 or email: events@rvcsbc.org. This program is brought to you by the McBride Adult Literacy Program.

**THUR., October 31st** you are invited to a Murder Mystery at the Theatre at the RVCS office in McBride, 942 3rd Ave. from 1:00pm-4:00pm. Registration is required, please contact the office 250-569-2266 or email events@rvcsbc.org for more information. This program is brought to you by the McBride Adult Literacy Program.

**MON through THURs**, McBride RVCS (942 3rd Ave.) has a FREE FOOD PANTRY that's available to all! Emergency top-up food is accessible to our clients, Family Place Drop In program and anyone who walks through the door. We share and accept donated foods that are safe and fresh for use, this project is made possible thanks to grant funding from United Way of BC, and the residents of the Robson Valley! Contact RVCS at 1-844-324-2004 or email foodsecurity@rvcsbc.org. The local Food Bank is also available: 250-569-3186.

## BUY, SELL, RENT & MISC.

**For Sale**-Winter tires. 215/60/R17. 2 new tires on rims. 2 used tires on rims. Good deal. Phone 250-569-4201 • **For Sale**-Set of 267/60/R20 Mud & Snow Studded Tires. Avalanche Extreme. Low Mileage. Ph: 250-569-7761 • **FREE**-Kittens ready to go. 3 black & white, 2 siamese types. Greggo, up the Beaver • **For Sale**-1998 Mercedes C230 - \$9700.00. 1988 Mercedes 560SEL \$15,000. 2003 Ford Explorer Eddie Bauer \$9000.00. 1966 Case 930 Comfort King \$3000.00. All good running condition - for more information call 250-569-7814 • **For Sale**-Stihl and Husky chain saws, a good selection of bars and chains to get ready for firewood season. Phone Warren Ph: 250-569-7469.

Please contact **The Little McBride Paper** with all coming events, news, trivia, comments, etc!! Phone: 250-569-3110, email: contact@fpas.ca, P.O. Box 441, McBride, B.C. V0J 2E0 or drop off at 455 King St. If we don't know about it, we can't inform the public about it! And check out our website www.fpas.ca.

Scott & Susan (Oscar & Broom)

All articles and ads are not the expressed opinion of this paper or it's owners.

**Take a Break in McBride...B.C.s Friendliest Town!!**

## Cougar Den Cabins

250-569-7308

Daily, Weekly & Monthly Rates  
1800 Samson Rd. McBride (bottom of Lucille mountain)

Grass fed beef quarters for sale.

\$5.50/Lb. hanging weight  
plus \$120 for disposal &  
transportation fee per quarter with  
cut/wrap \$.95/Lb.

For more information contact  
Melanie at (250) 793-4742

Heartland 250-569-0032

## RESTAURANT

Looking for SERVERS and  
part time DISHWASHERS.

Come talk to Josh at Heartland Restaurant

## Meraki Builders

Construction and Renovations

250 569 7885 (Mitch) 250 569 4109 (Brenden)



## RICH BOYZ MECHANICAL LTD.

JTR 2002-2021

Heavy Duty/Commercial Transport Repairs  
CVSE Inspection Facility Commercial Truck Parts  
Monday-Friday 9-5 250-569-2470



## D & T INDUSTRIES

250-569-7758 / 7050

#### NEW HOURS

MON. - FRI. 6AM-5PM SAT. 9AM-5PM

SUNDAY CLOSED

PATIO OPEN 250-569-0133

Mon.-Fri. 6am-5pm, Sat. 9am-5pm Closed-Sun. & Stat Holidays

**TGP McBride TGP Grocery Store**  
The Grocery People  
211 Main Street 250-569-2525

Oct. 17 - 23

Dr. Oetker

Ristorante or Di Mama Pizza

325-410g 3.99 lb.

Check Out all of our  
UNBELIEVABLY Low Prices

We have  
HALLOWEEN CANDY  
In-Stock

Small Businesses are the  
Heart of  
your Community

OPEN 365 Days a Year 8am-8pm

Bank. Borrow. Invest. Insure.

## INTEGRIS CREDIT UNION

Become a member today!

integriscu.ca 1-866-554-3456

## Book Your Septic Pump Out Before Winter!!

If you don't remember when it was last pumped...  
It's time!! 2 - 5 years depending on usage. One year  
for a B&B!! Don't let solids plug up your drain field!!

### Porta Potties

We have nice clean porta potties to help with your  
Reunions, Weddings and Construction Sites  
**Robson Valley Septic & Water Hauling**

Dome Creek, McBride, Dunster, Valemount, Blue River  
(250) 569-7812 "The Friendly Little Truck!!"

# WORLD FOOD DAY

The  
Goat Shed

AGRICULTURE  
AREAS  
CELEBRATED  
COMBAT  
CONFLICT  
CONTRIBUTE  
DATE  
FOOD  
FOUNDING  
FUND  
GROW  
HEALTH  
HUNGER  
NATIONS  
NOBEL  
NOURISH  
OCTOBER  
PEACE  
PRIZE  
SECURITY  
SIXTEENTH  
SUSTAIN  
UNITED  
WORLDWIDE  
YEAR

C D M J F O W J G U U Q C S E  
Y E A R C O M B A T J F O U X  
W F L T R H U F C S U G N S X  
Y F Y E E S Z N O N R V F T T  
X O Q Z B I W U D O S N L A G  
U F I W O R L D W I D E I I S  
E R M I T U A E X T N H C N R  
P R Z B C O R T S A P G T Q S  
E L E B O N E I E N F C X P O  
A B O G I E A N C D A O H T P  
C G B V N C S U U R X E D A B  
E R U T L U C I R G A T P Y L  
W Z H R L K H A I L J I Q H P  
J O E T U B I R T N O C Z O S  
Y U E H S F V H Y Q V R T J V

Take a Break in McBride...B.G.s Friendliest Town!!